

Access to the Examination Rooms

- The examinations take place in the following rooms:
 - Building 2: 2.103, 2.149, 2.150a, 2.150b, 2.151
 - Building 55: 55.010, 55.014, 55.015, 55.022
- When accessing the rooms, the student ID card, an official ID document and the notification sheet about COVID-19 preventive measures signed by you must be presented.
- Access to the rooms is only possible via the marked routes.

Building 2 (Laboratory Building)

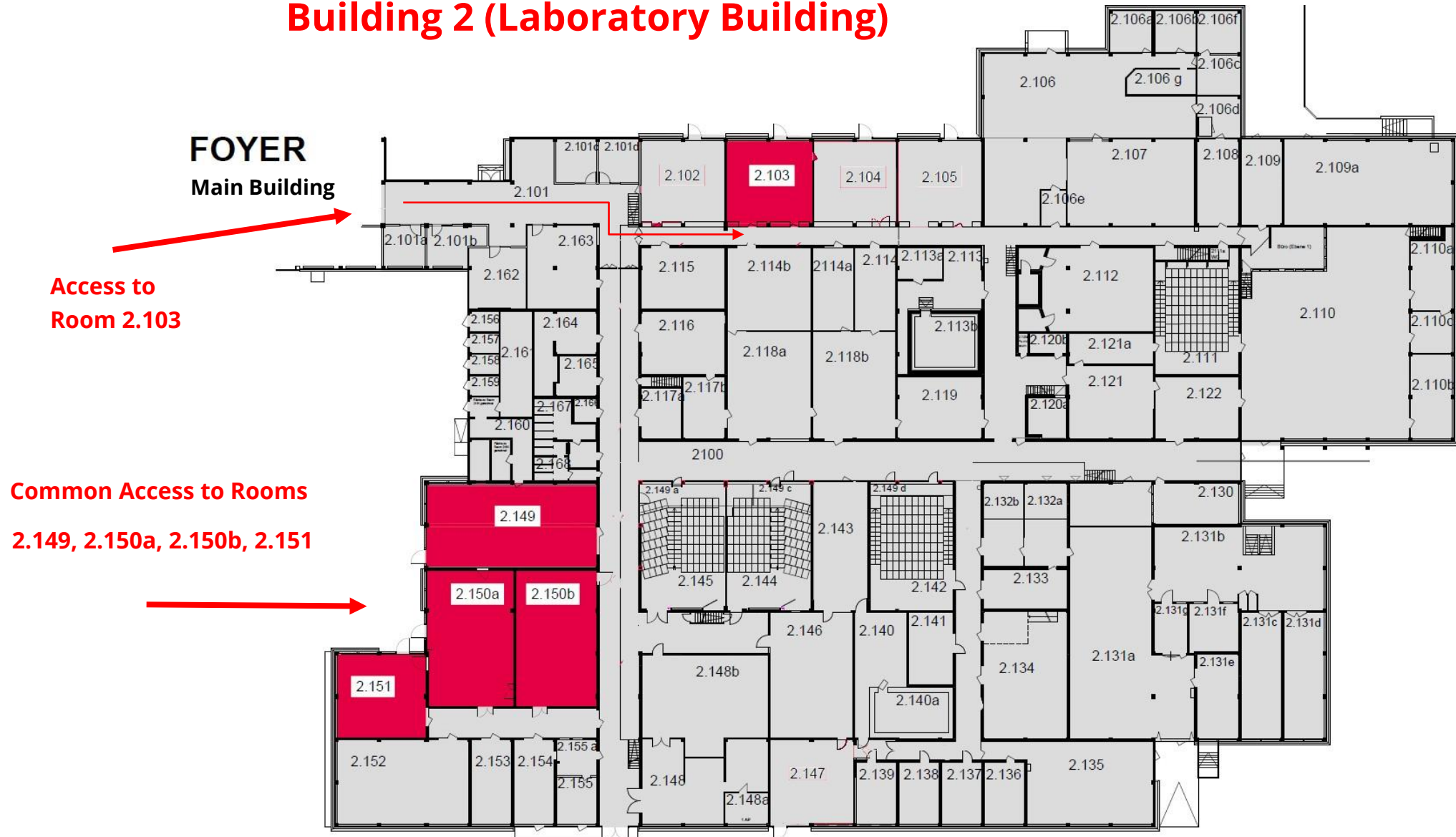

Building 55 (Container Complex)

